

SECRET'40 interior con viga superior

100 kg

INSTALACIÓN, DESDE EL SUELO TERMINADO
MOUNTING ON FINISHED FLOOR LEVEL

TABLA | BOARD 40 mm

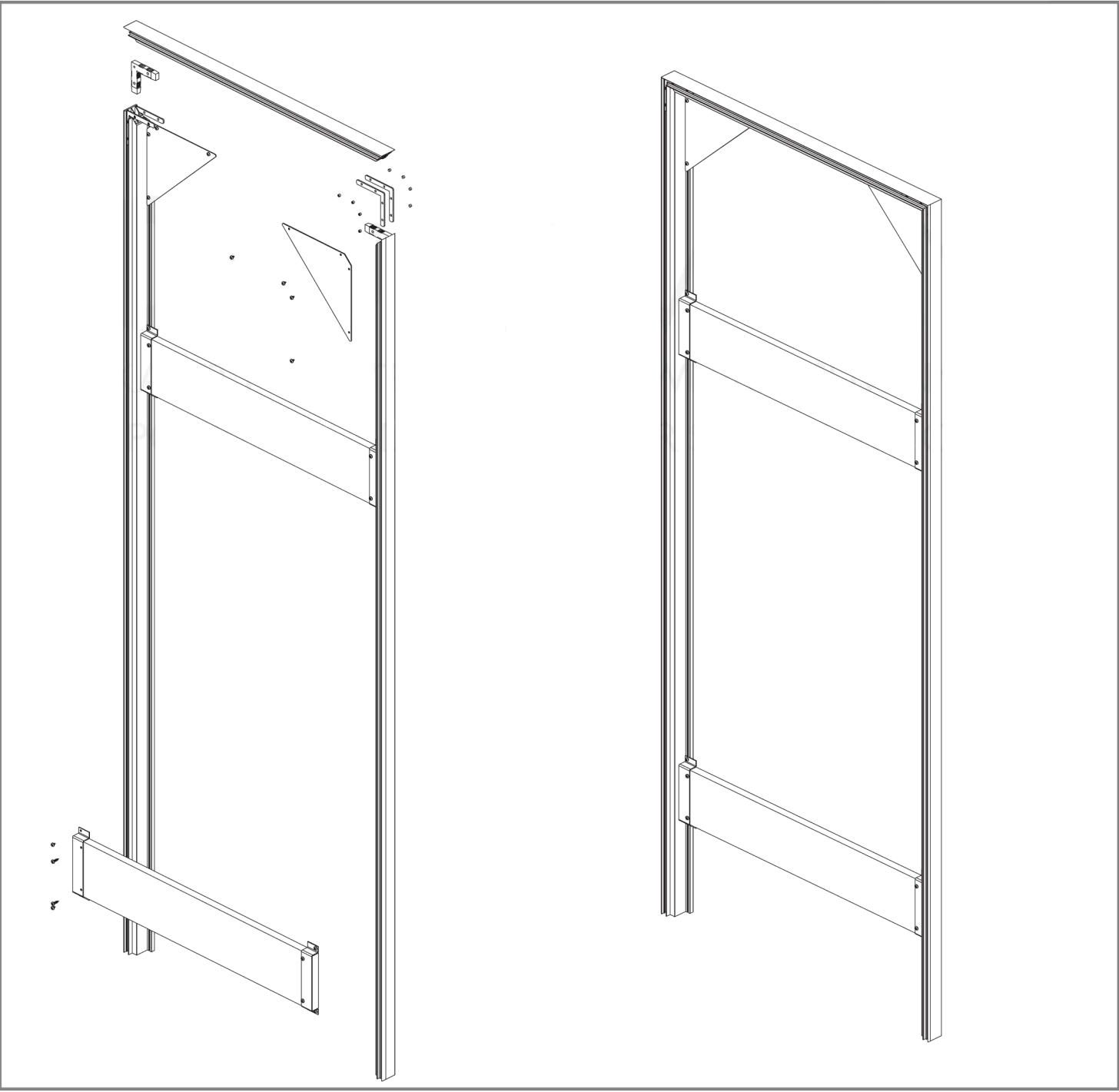
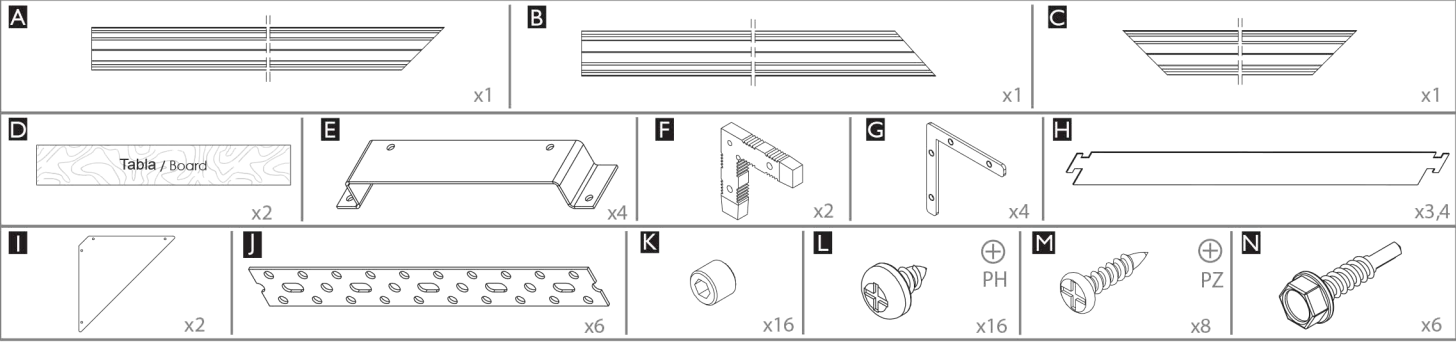
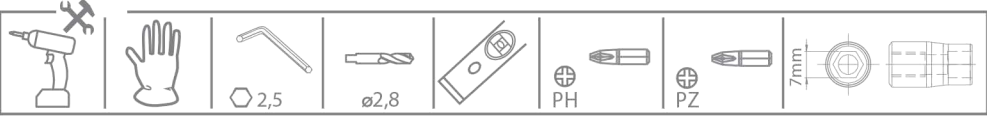

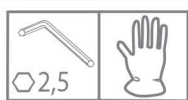

C, F, G, K

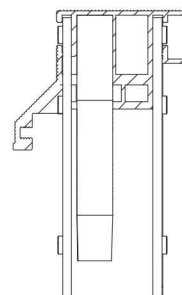
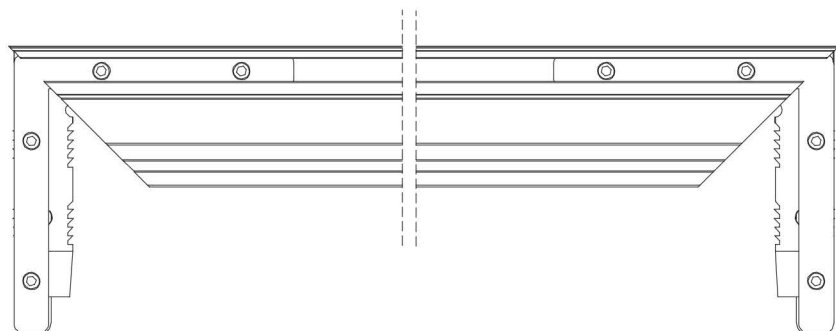
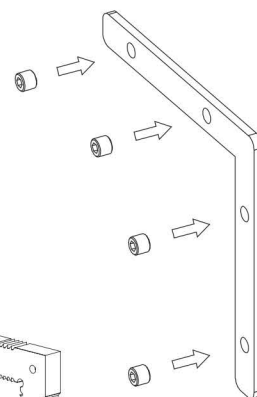
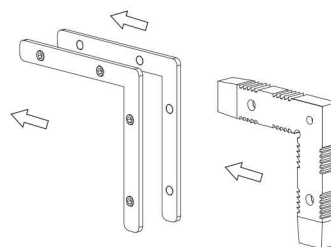
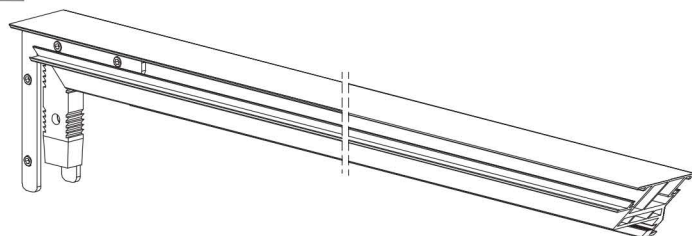

A, B

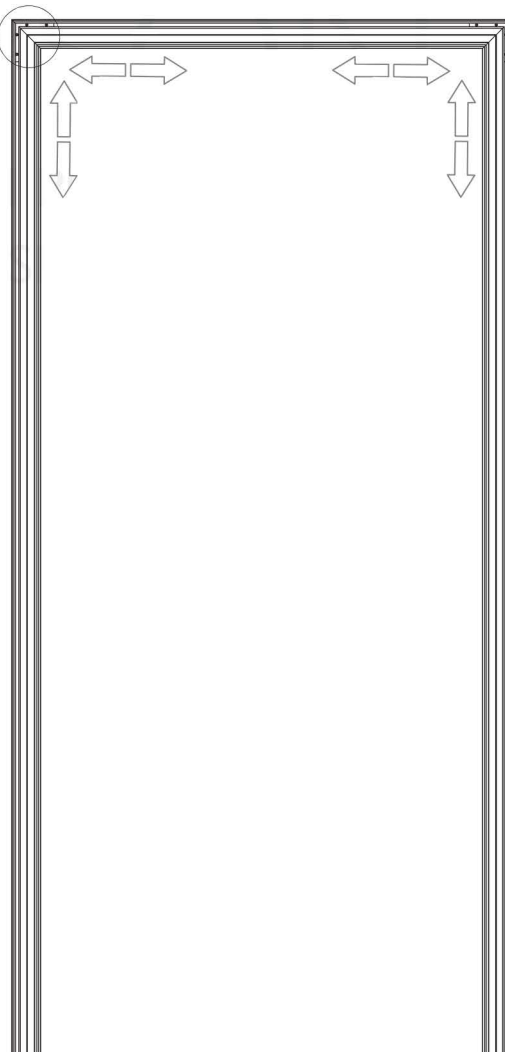
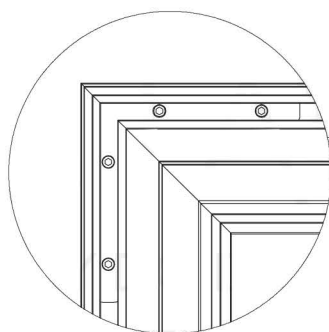
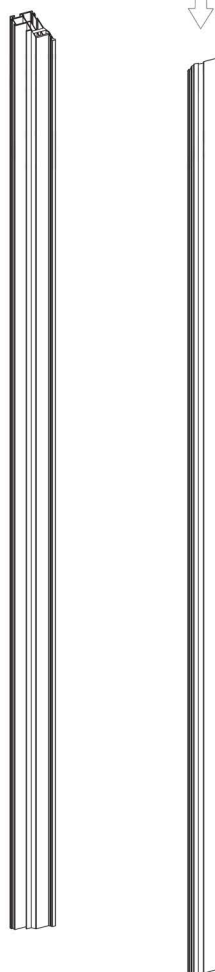
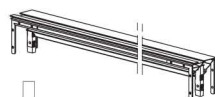

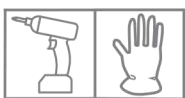

D, E, H, K, L

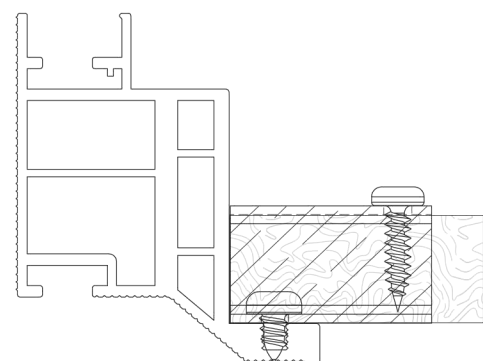
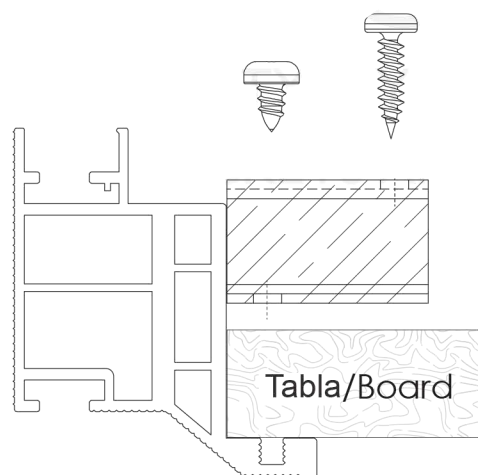
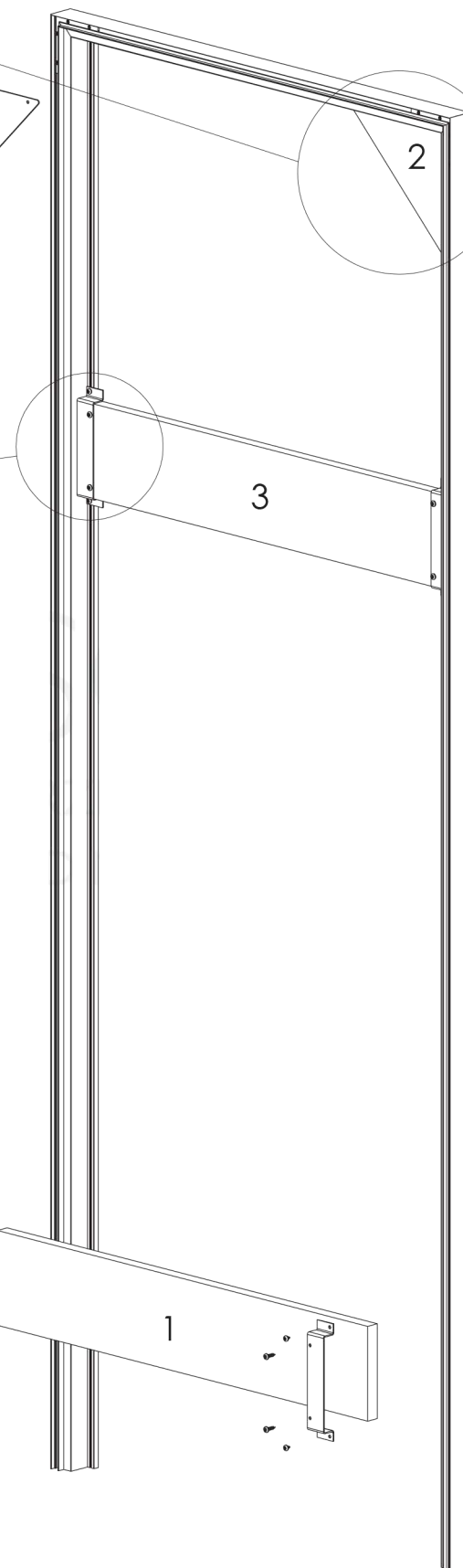
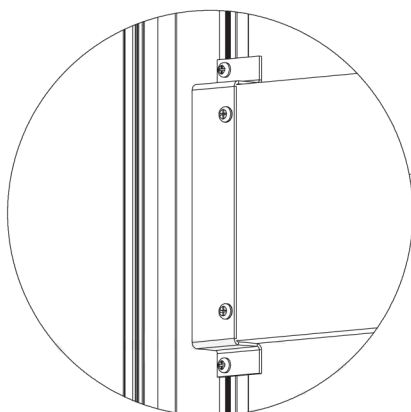
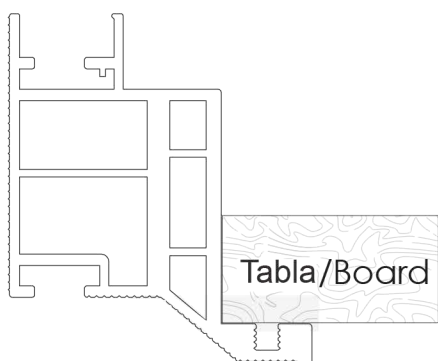
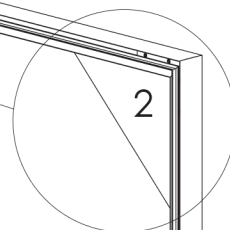
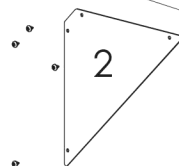
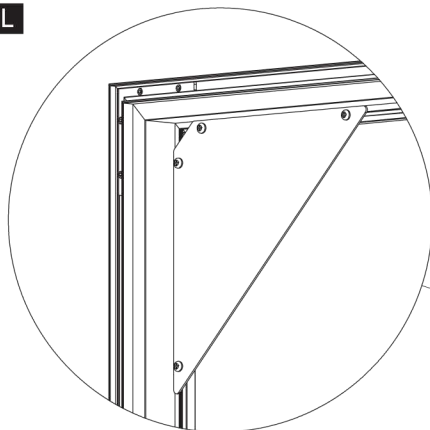
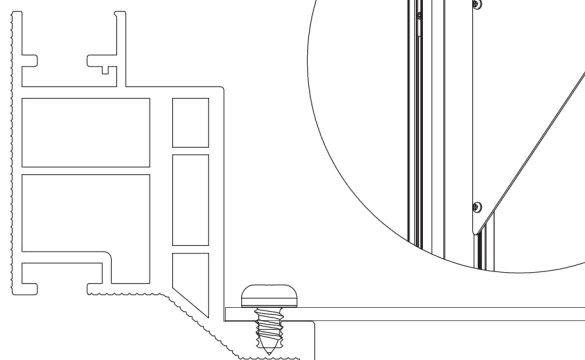

Montaje de pared de carton-yeso. Placa de 12,5 mm
Montage Stud Wall

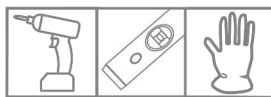

En el caso de diferentes tipos de suelos, se recomienda el uso de cuñas para elevar el marco de la puerta. Use the wedges to lift the frame in the case of various types of floors.

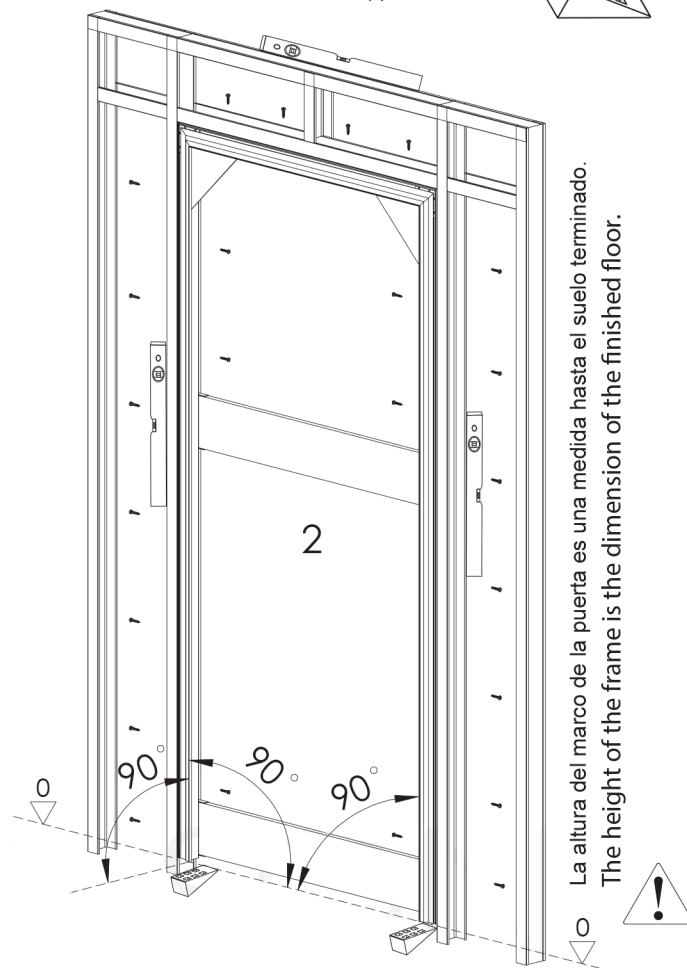
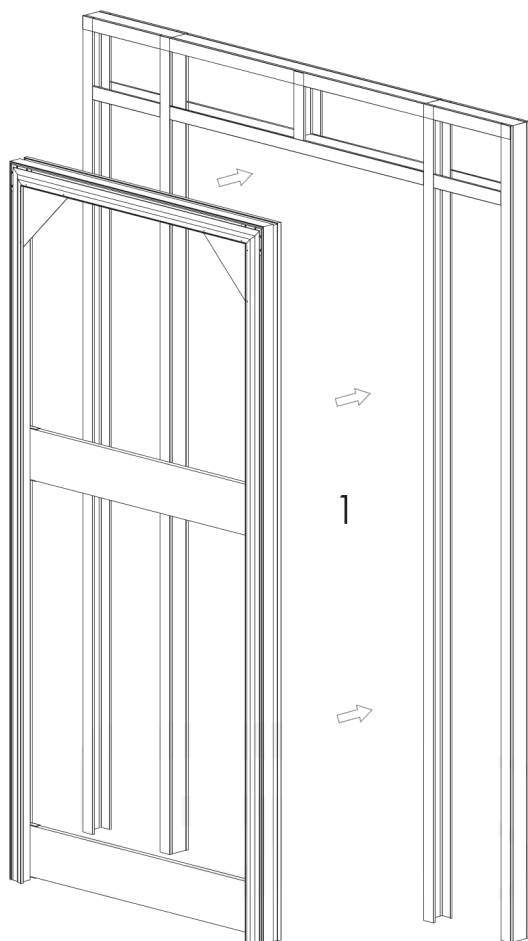

La altura del marco de la puerta es una medida hasta el suelo terminado.
 The height of the frame is the dimension of the finished floor.

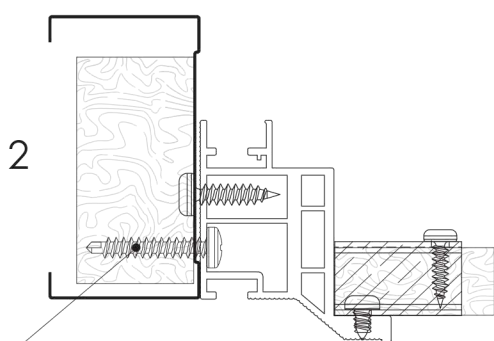

En los agujeros de las bisagras, atornille tornillos adicionales para reforzar alrededor de las bisagras.
 In the hinge holes screw additional screws for reinforcement at the hinges.

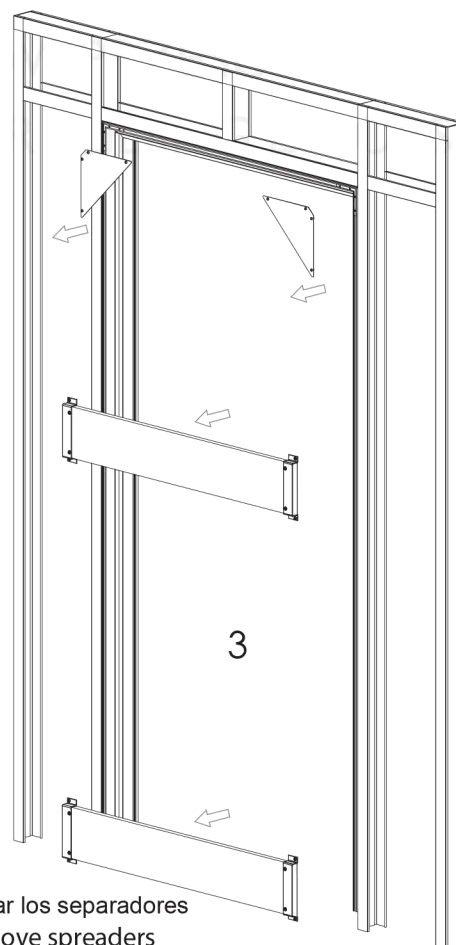

Quitar los separadores
 Remove spreaders

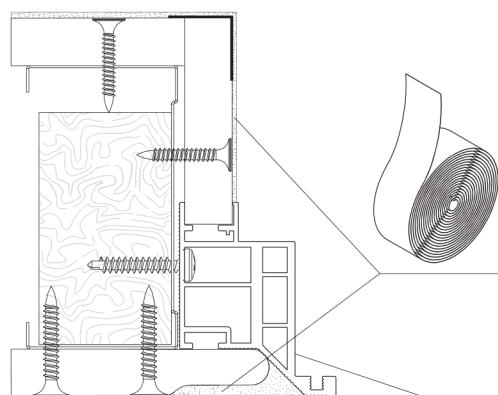
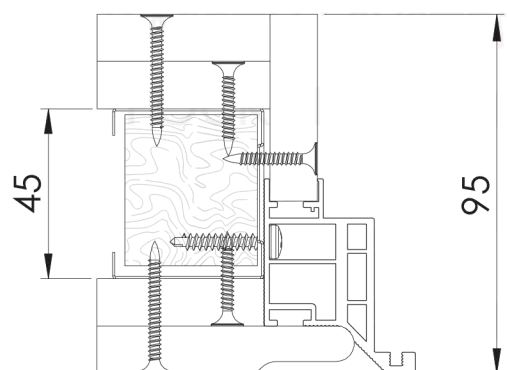
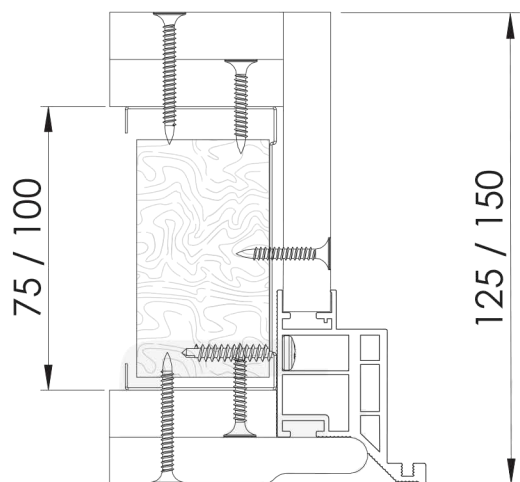
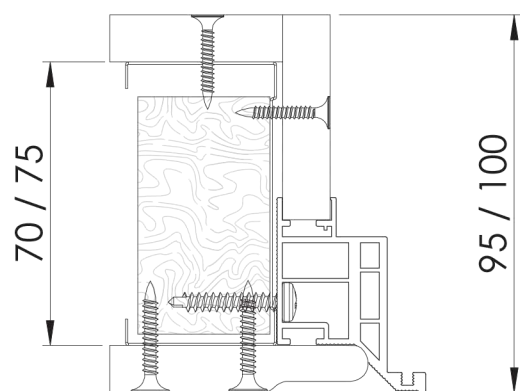

Enyesar: Primera capa, masilla de grano grueso
 Segunda capa, masilla de acabado
 Al enyesar, usar cinta o malla de refuerzo en las uniones.
 Fill: First coat, coarse spatula, Second layer of finishing spatula
 When skimming use a nonwoven or reinforcing mesh on all joints.

Quitar la lámina protectora de los perfiles.
 Los perfiles se pueden pintar con pinturas para paredes.
 Remove the protective foil from the profiles.
 The profiles can be painted with wall paint.

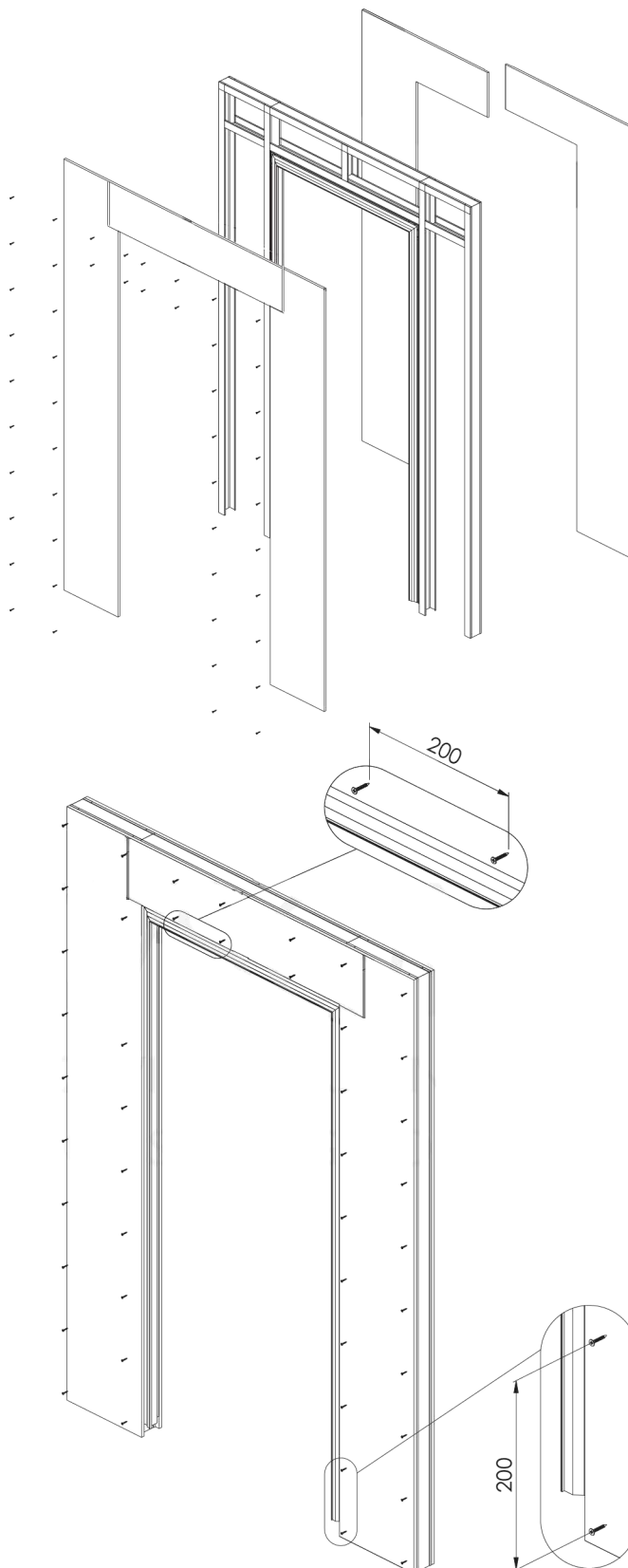

Montaje de pared de ladrillo Montage Solid Wall



J, N

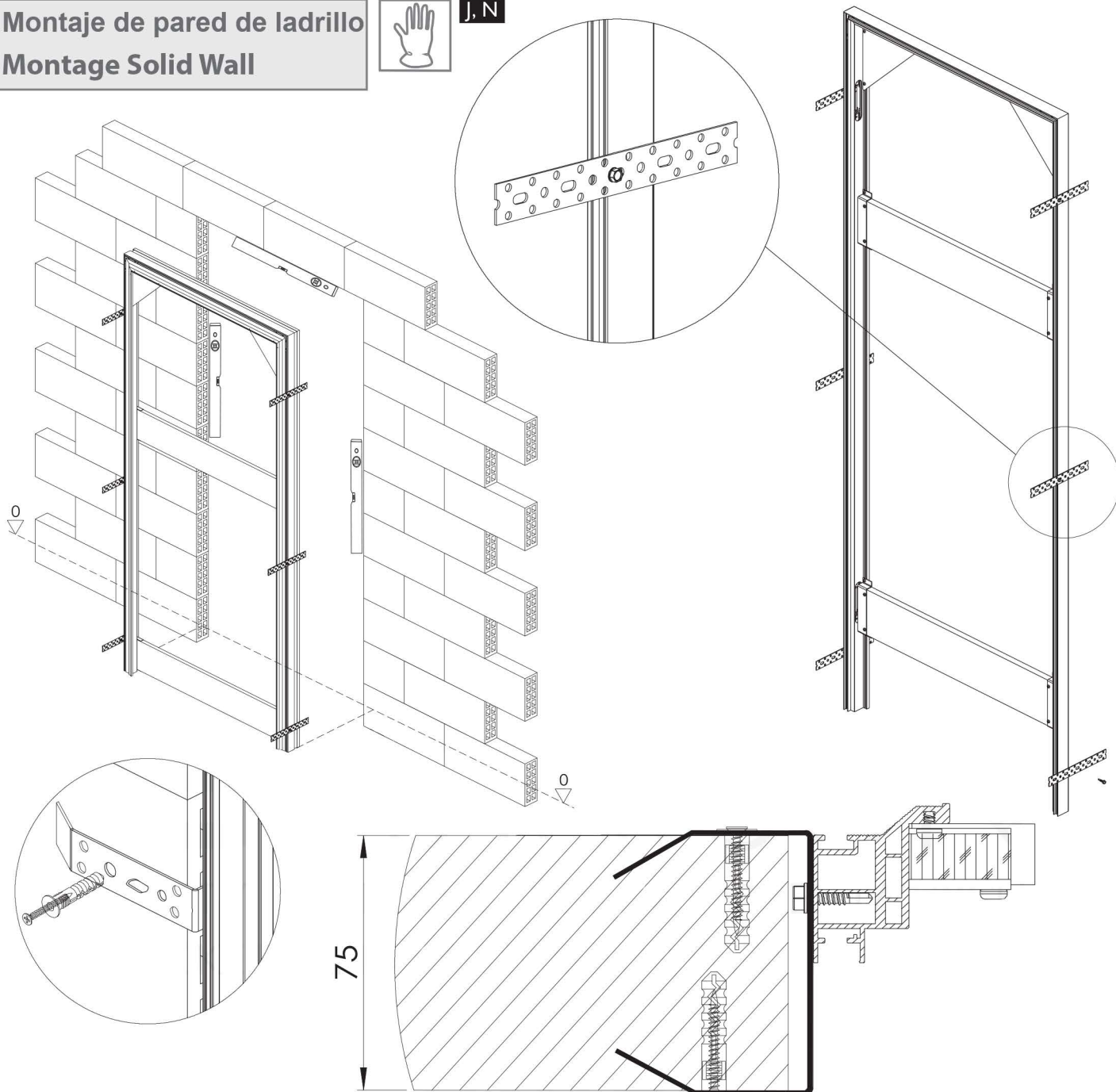

H

Fijar en el perfil.
Pin in profile.

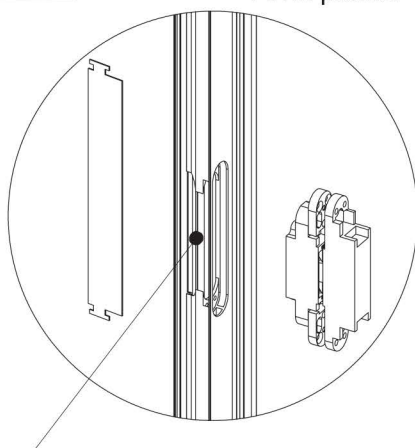

Sitio para las bisagras.
Place for Hinges.

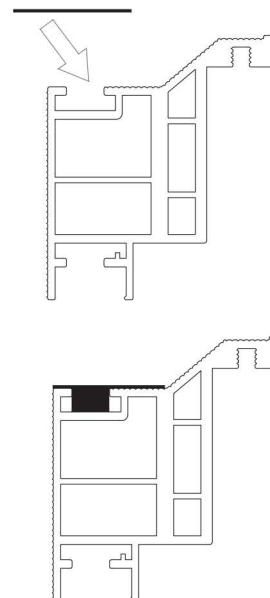
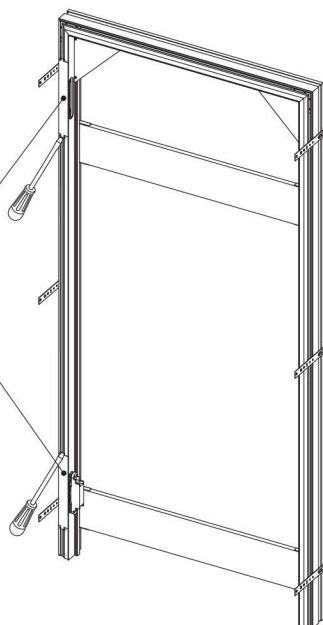



En el caso de diferentes tipos de suelos, se recomienda el uso de cuñas para elevar el marco de la puerta.
Use the wedges to lift the frame in the case of various types of floors.

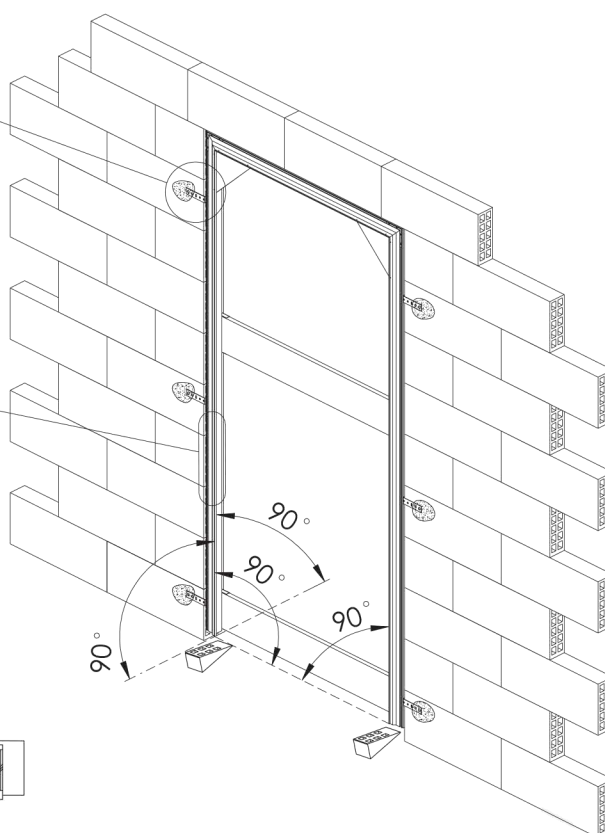
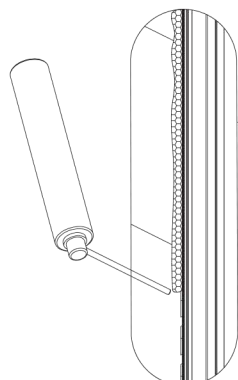
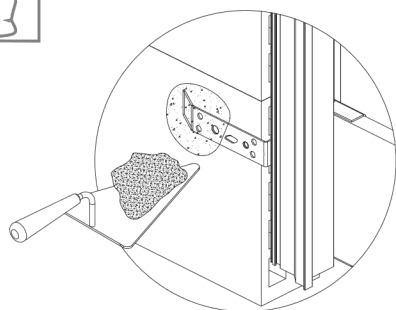

La altura del marco de la puerta es una medida hasta el suelo terminado.
The height of the frame is the dimension of the finished floor.

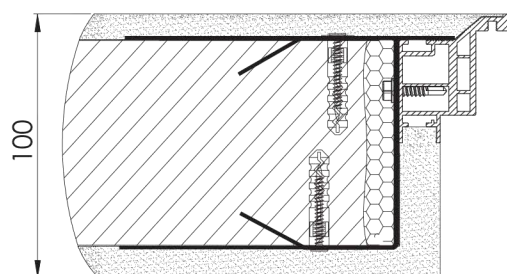
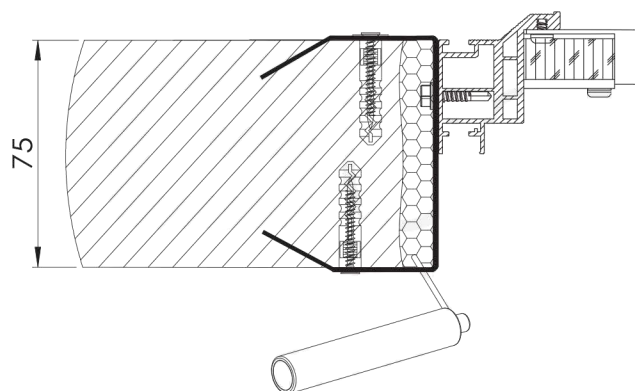

Al enyesar, usar una malla de refuerzo en las uniones.
When using plastering, use reinforcing mesh on the joints.

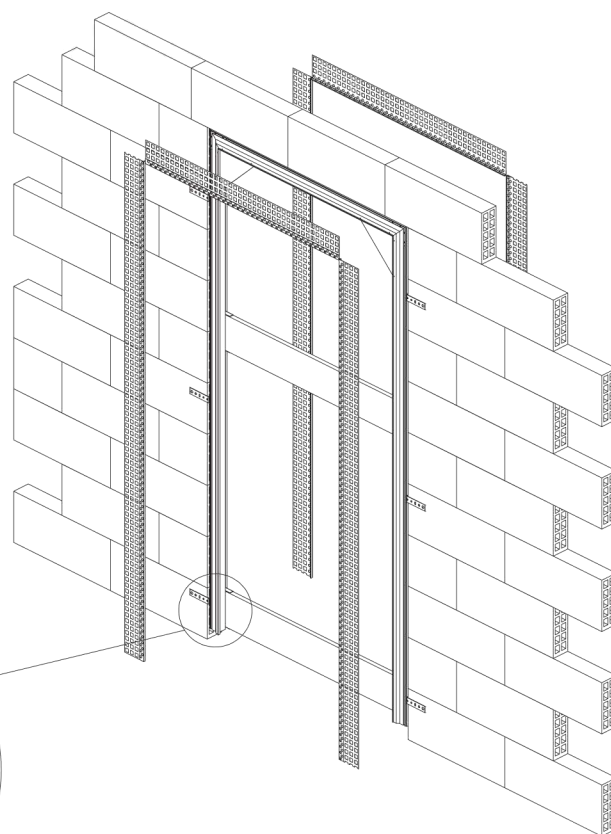
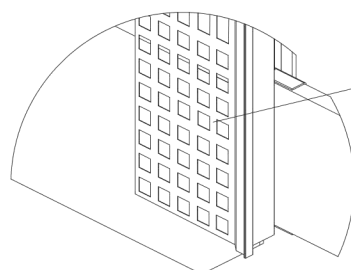
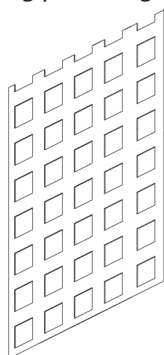

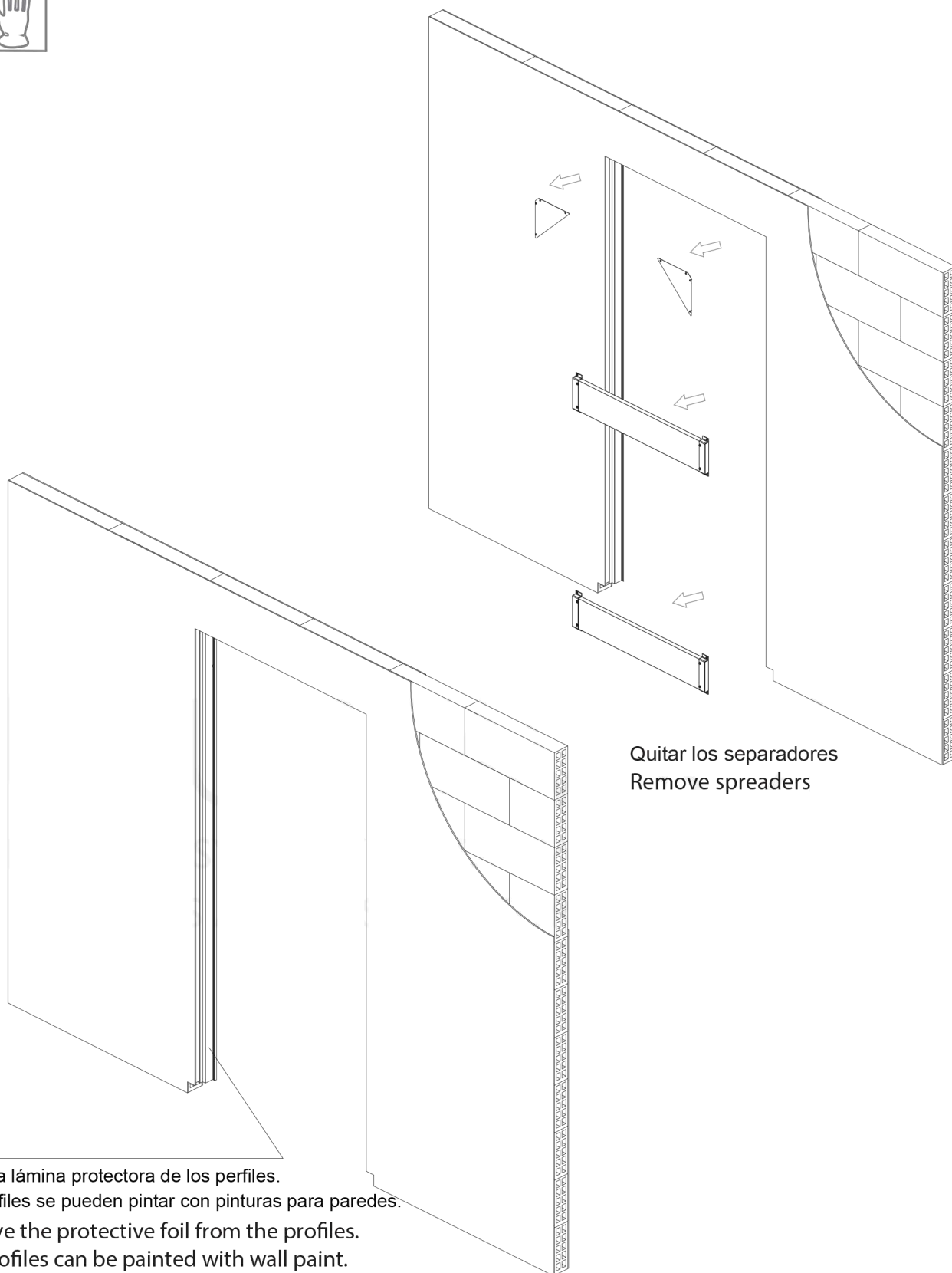

Quitar los separadores
Remove spreaders

Quitar la lámina protectora de los perfiles.
Los perfiles se pueden pintar con pinturas para paredes.
Remove the protective foil from the profiles.
The profiles can be painted with wall paint.

Las rayaduras del producto en la superficie blanca, cubierta con una capa de pintura de imprimación, no afectan las características esenciales del uso del producto - no constituyen una base para reclamaciones ni están cubiertas por la garantía del fabricante. La capa de imprimación sirve para ser recubierta con una capa de pintura final u otro material de acabado final elegido por el cliente.

Scratches on a white surface covered with a primer paint do not affect the product's essential functionalities - they are not a basis for a complaint and are not covered by the manufacturer's warranty. The undercoat layer is used to cover with the target paint coat or other target finish material chosen by the customer.

Se recomienda seguir estas instrucciones utilizando las herramientas adecuadas y de acuerdo con las indicaciones. En el caso de elementos cuya superficie pueda ser afilada, se deben utilizar equipos de protección individual y asegurar el área de trabajo. La empresa se exime de responsabilidad por las acciones resultantes de no seguir estas instrucciones.

It is recommended that you follow these instructions using the appropriate tools as indicated. In the case of elements whose surface can be sharp, use personal protective equipment and work area protection. The company Laguna Hardware Factory Limited Liability Limited Partnership refrains from liability for actions resulting from conduct incompatible with this instruction.