

SECRET'40 interior sin viga superior

SECRET 40 inner without upper beam

100
kg

INSTALACIÓN,
DESDE EL SUELO TERMINADO
MOUNTING ON FINISHED
FLOOR LEVEL

TABLA | BOARD 40 mm



Antes del montaje, verifique la conformidad del producto: calidad, cantidad y dimensiones. En caso de no conformidad, debe notificarlo inmediatamente al vendedor.

Prior to installation check all elements of the set: finish quality, quantity, dimensions. In case of any issues please contact your supplier.

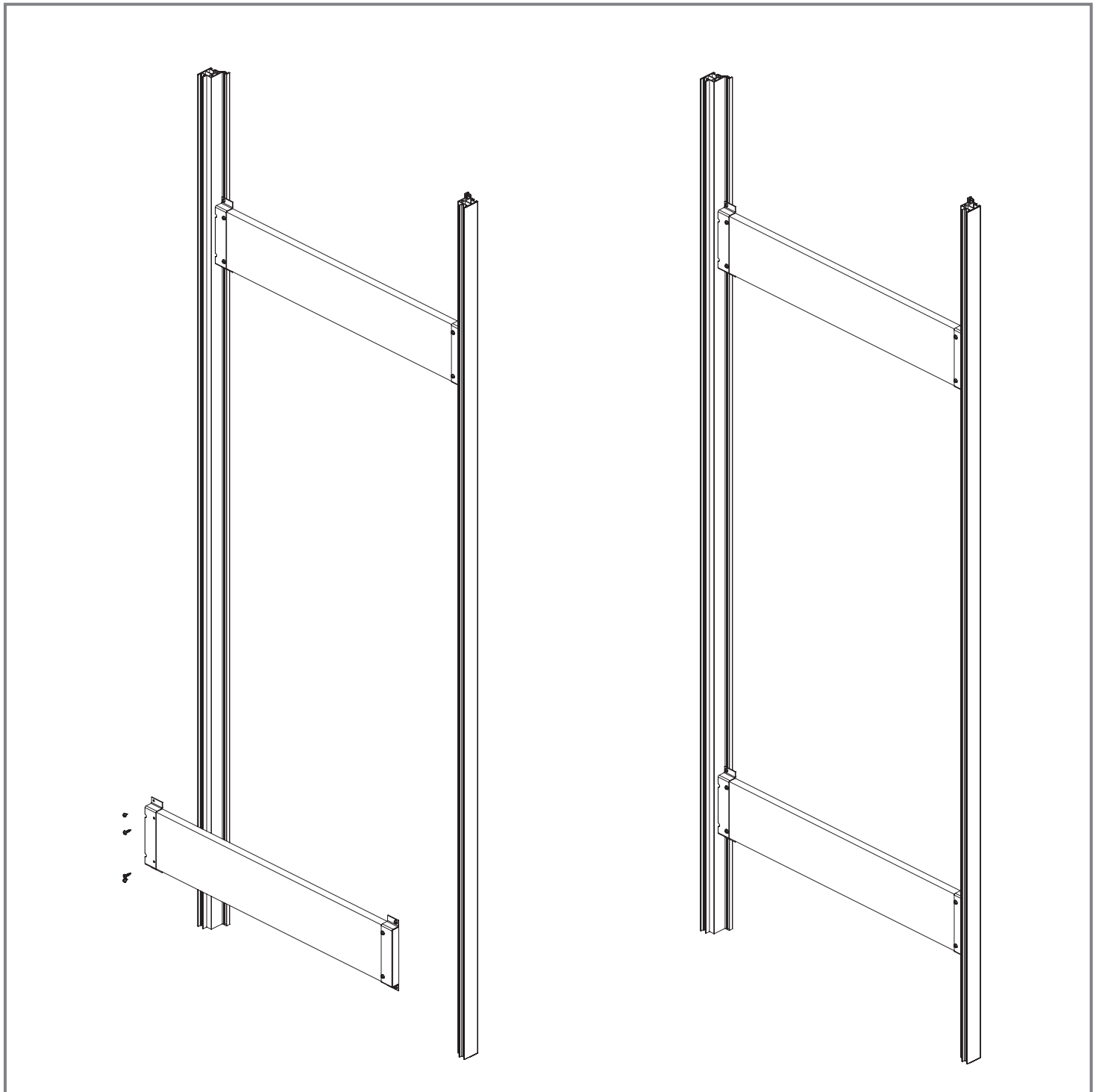
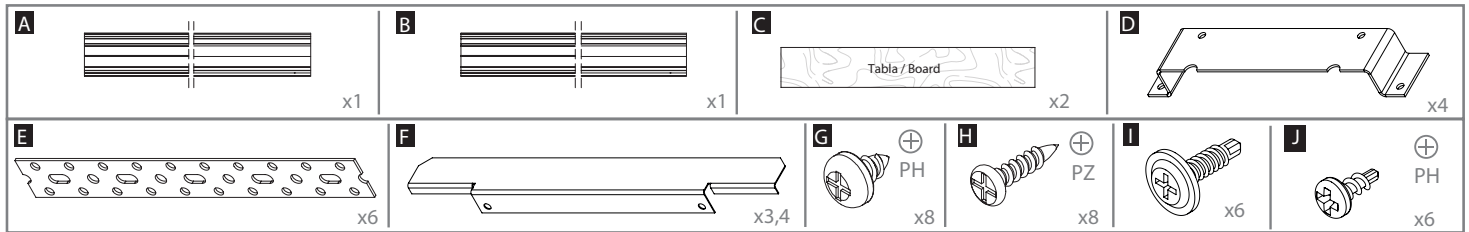
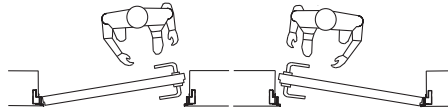
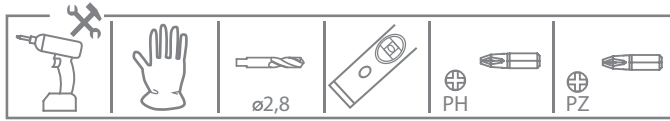



A, B, C, D, G, H

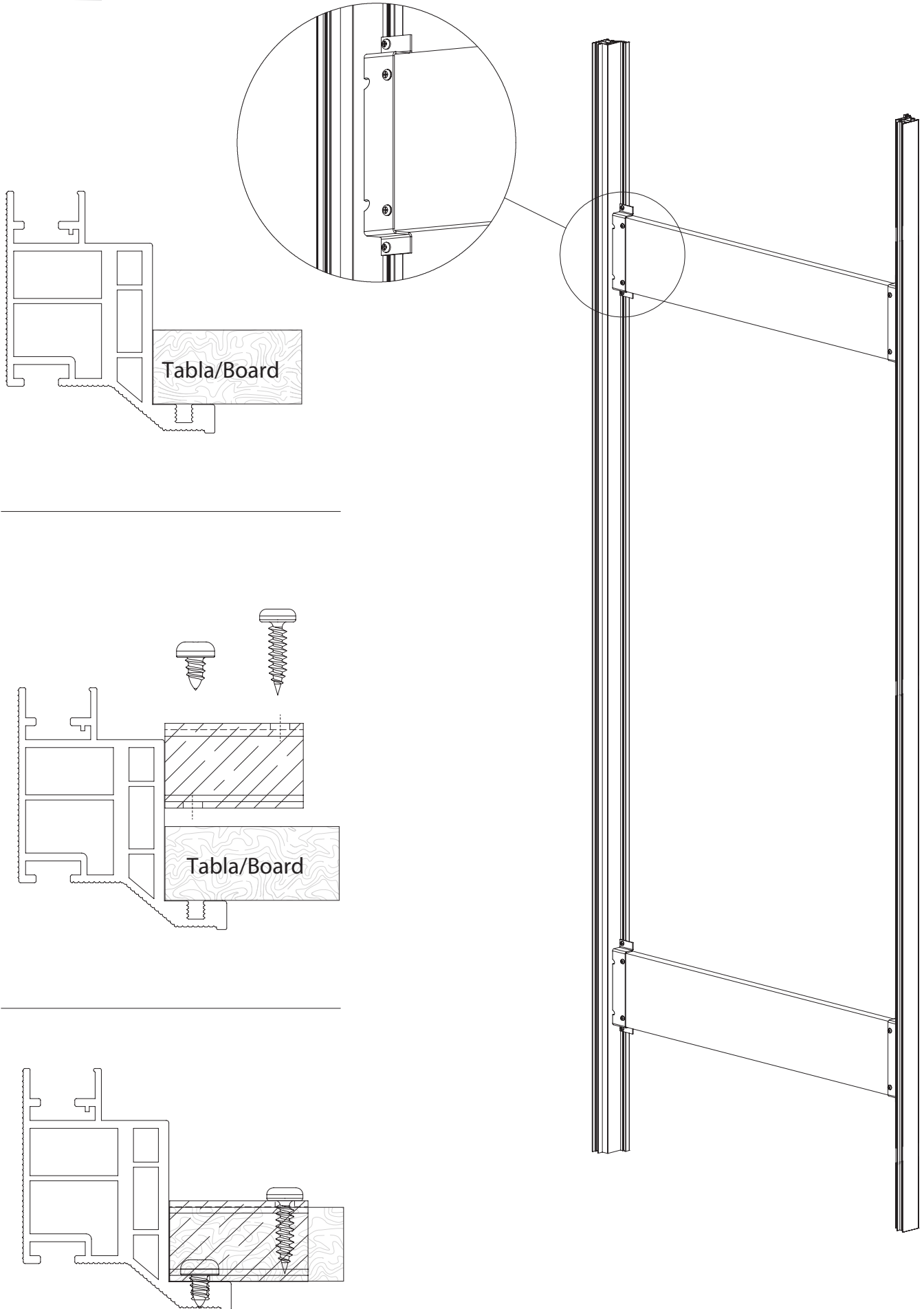

**Montaje en pared de cartón
- yeso placa de 12,5 mm
Montage Stud Wall**

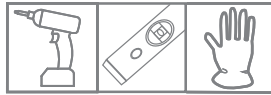

En el caso de diferentes tipos de suelos, se recomienda el uso de cuñas para elevar el marco de la puerta.
Use the wedges to lift the frame in the case of various types of floors.

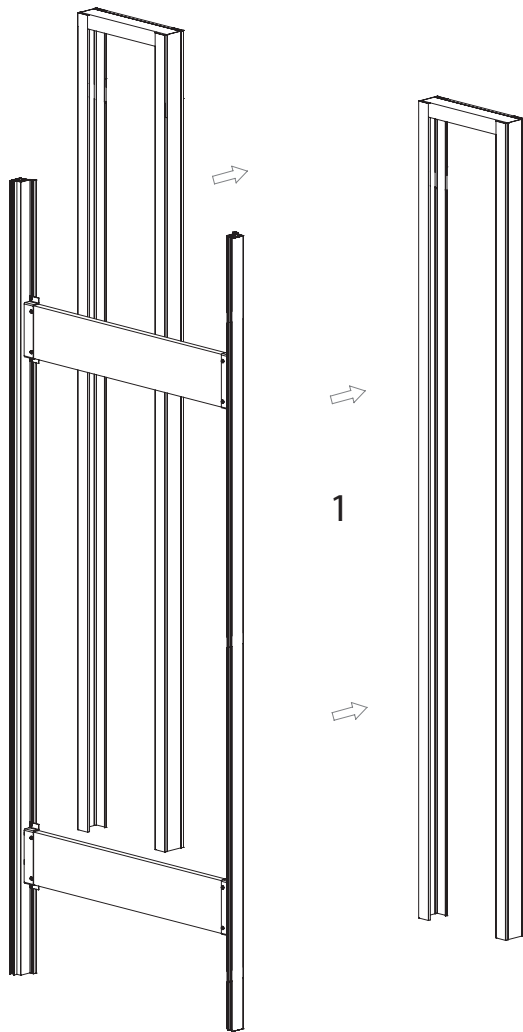
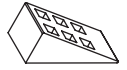

1

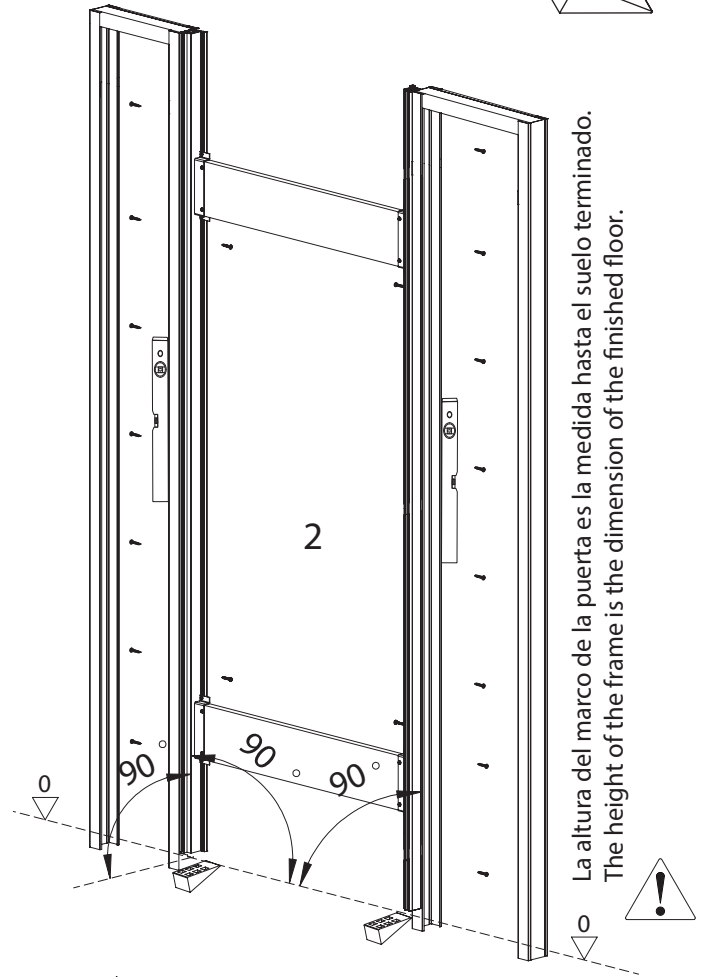

2

La altura del marco de la puerta es la medida hasta el suelo terminado.
The height of the frame is the dimension of the finished floor.

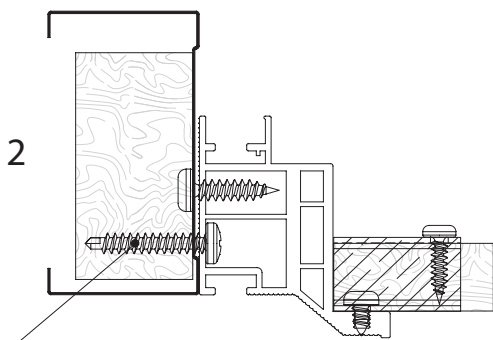

2

En los agujeros de las bisagras, atornille tornillos adicionales para reforzar alrededor de las bisagras.
In the hinge holes screw additional screws for reinforcement at the hinges.

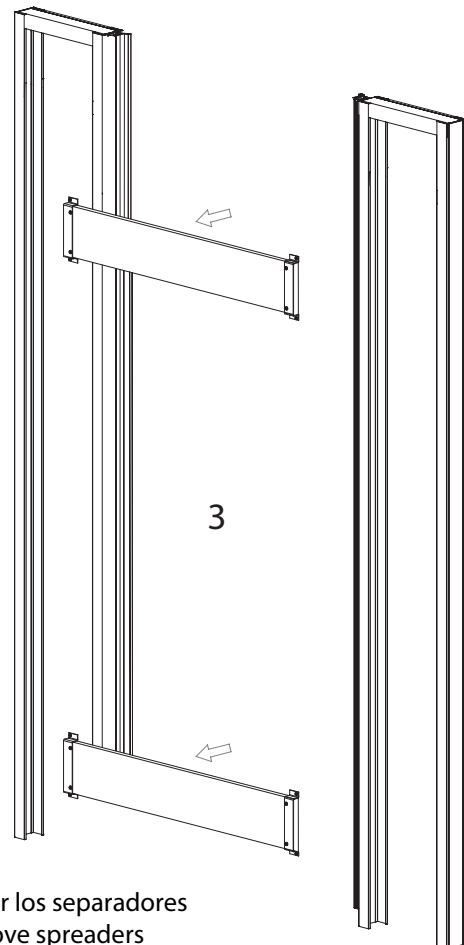

3

Quitar los separadores
Remove spreaders

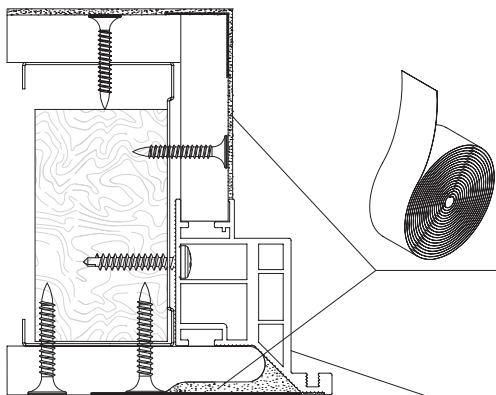
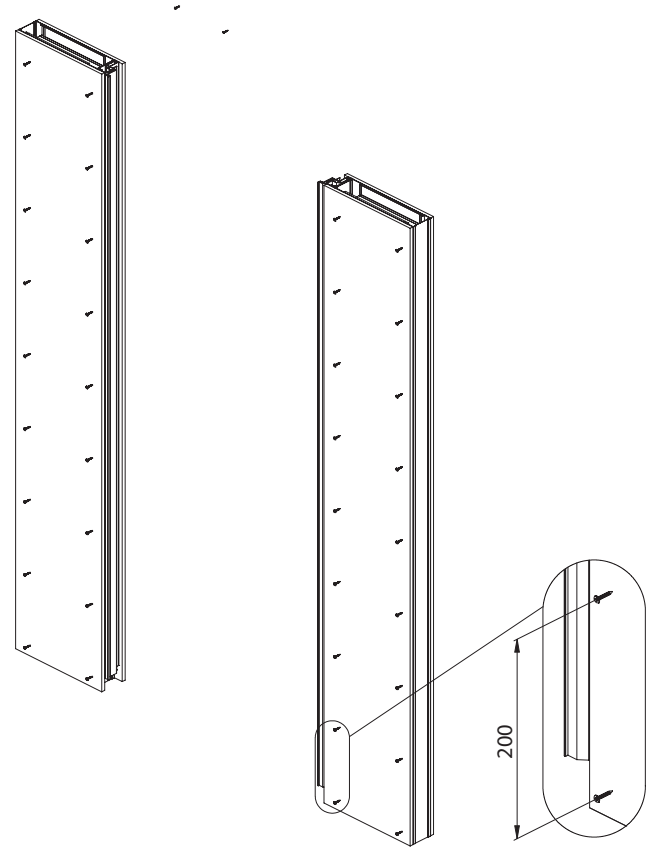
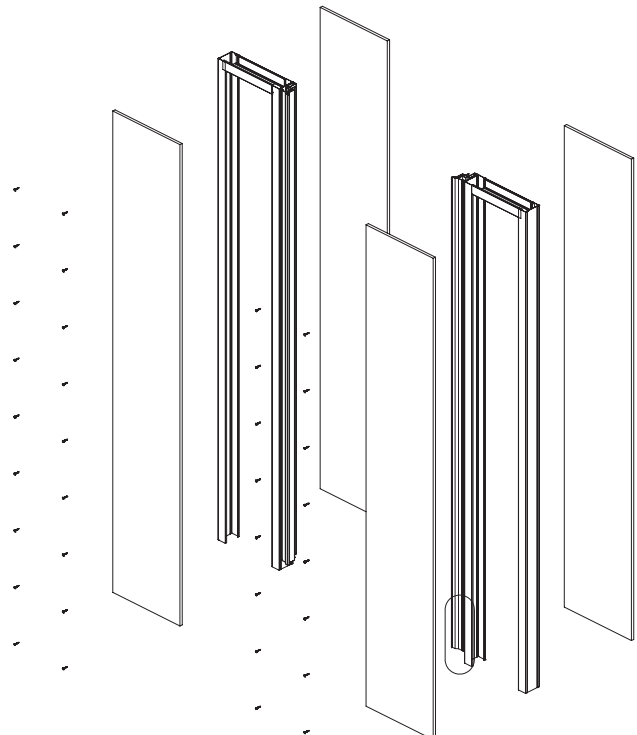
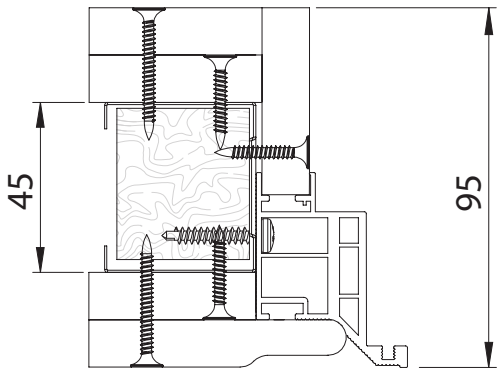
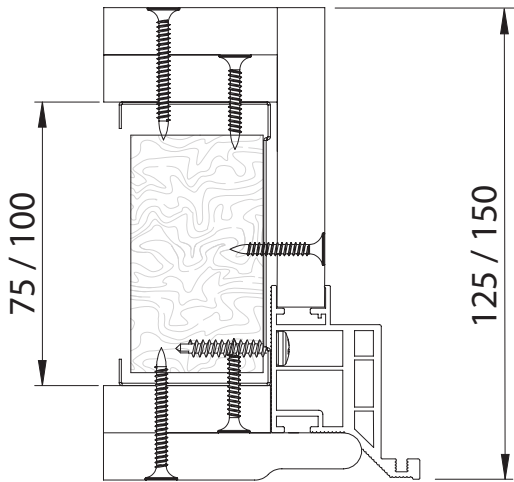
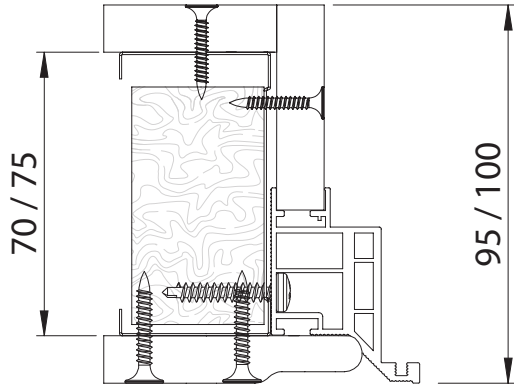

Enyesar: Primera capa, masilla de grano grueso Segunda capa, masilla de acabado. Al enyesar, usar cinta o malla de refuerzo en las uniones.
 Fill: First coat, coarse spatula, Second layer of finishing spatula
 When skimming use a nonwoven or reinforcing mesh on all joints.

Quitar la lámina protectora de los perfiles.
 Los perfiles se pueden pintar con pinturas para paredes.
 Remove the protective foil from the profiles.
 The profiles can be painted with wall paint.

Montaje de pared de ladrillo
Montage Solid Wall



E, I

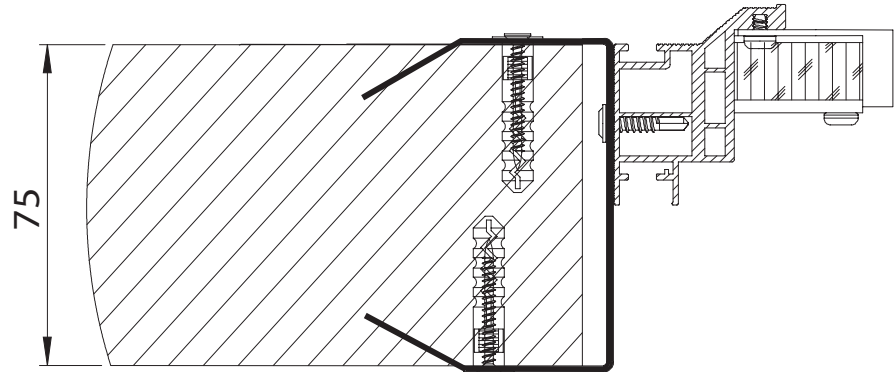
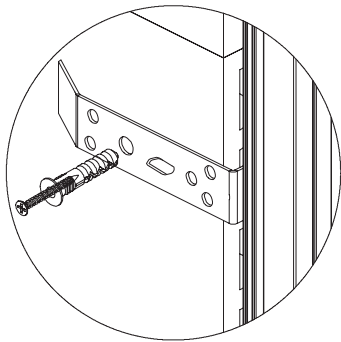
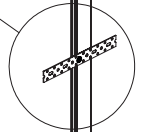
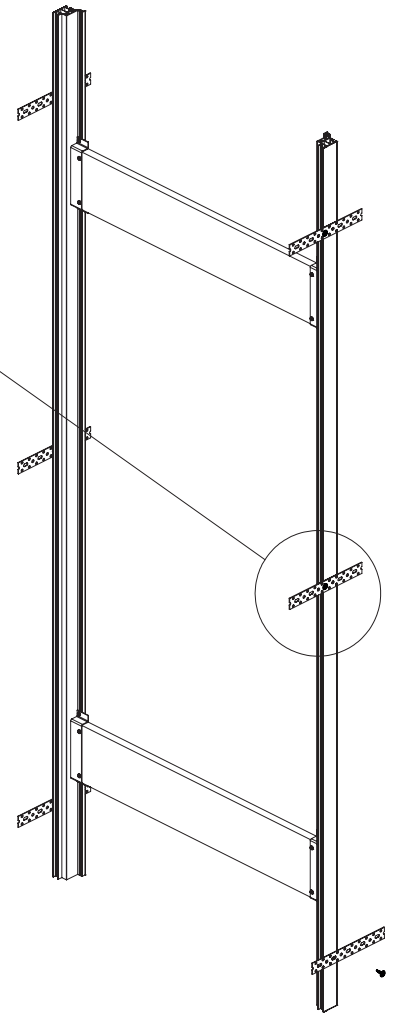
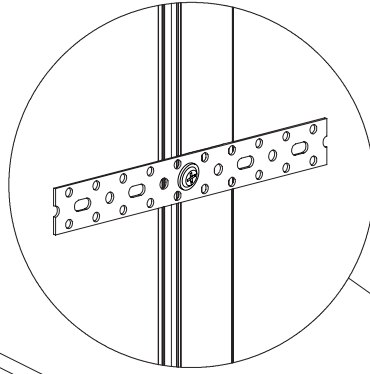
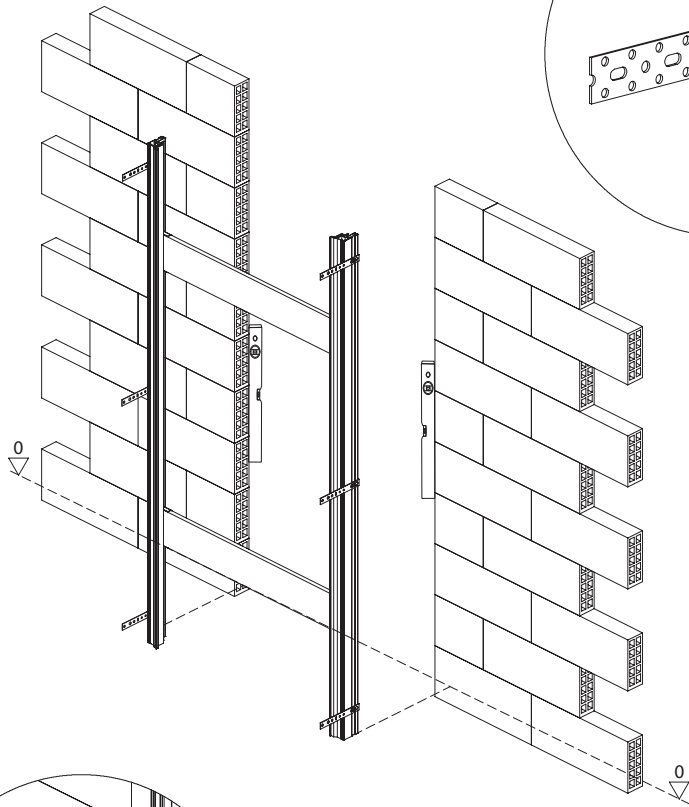

F, J

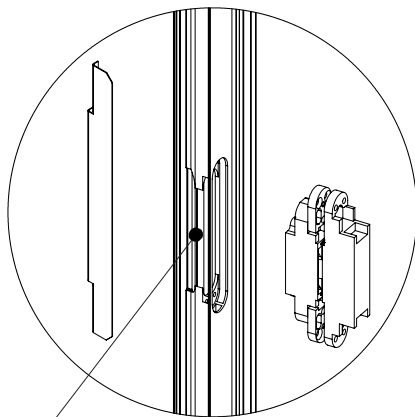

Sitio para las bisagras.
 Place for Hinges.

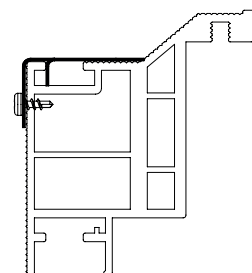
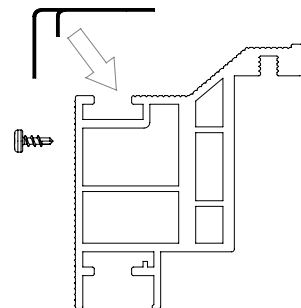
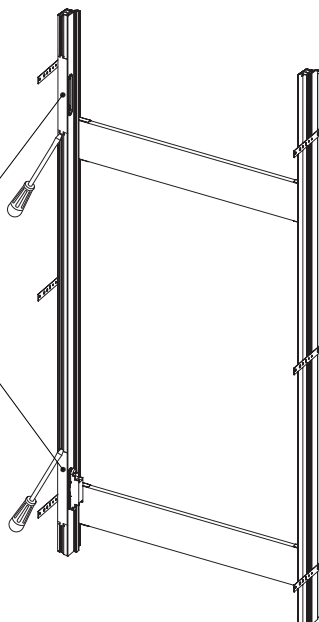



En el caso de diferentes tipos de suelos, se recomienda el uso de cuñas para elevar el marco de la puerta.
Use the wedges to lift the frame in the case of various types of floors.

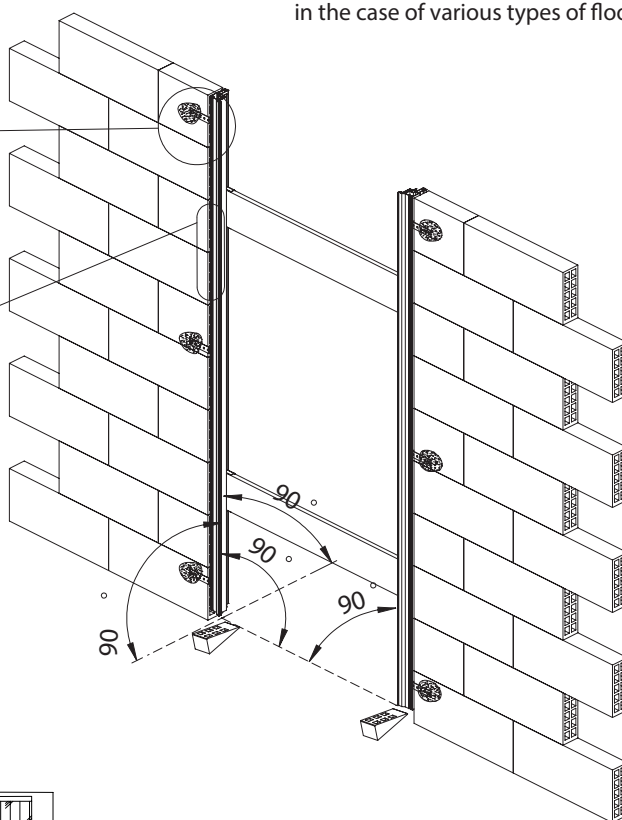
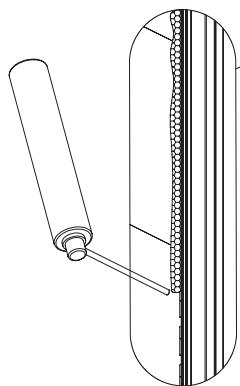
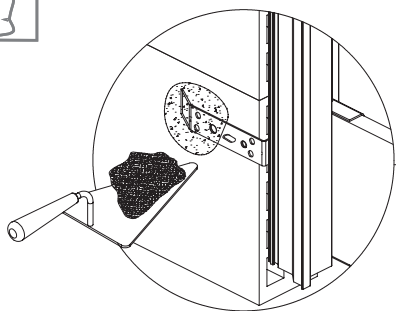
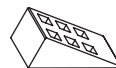

La altura del marco de la puerta es la medida hasta el suelo terminado.
The height of the frame is the dimension of the finished floor.

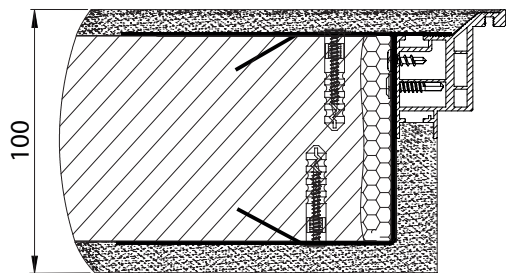
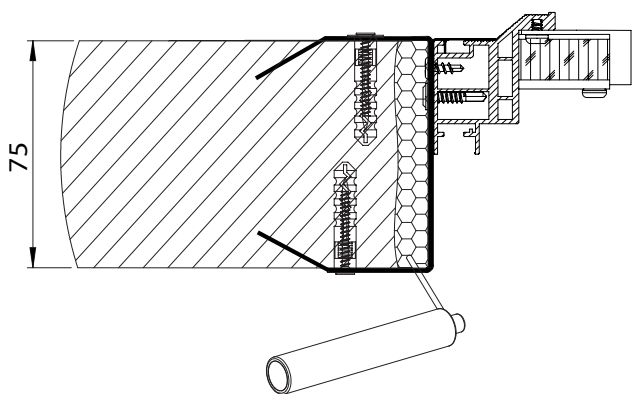

Al enlucir, utilizar una malla de refuerzo en las uniones.
When using plastering, use reinforcing mesh on the joints.

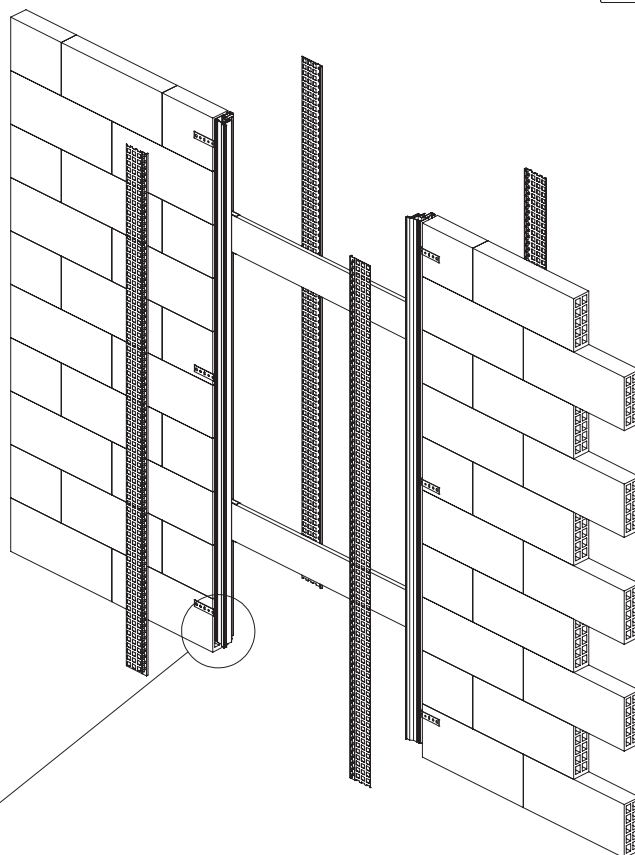
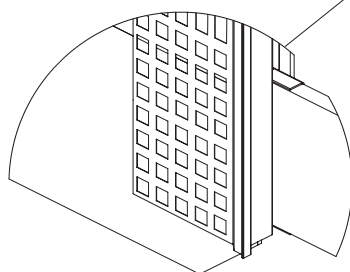
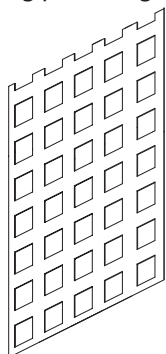

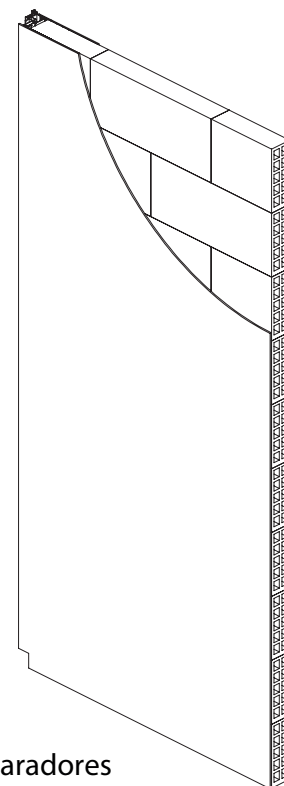
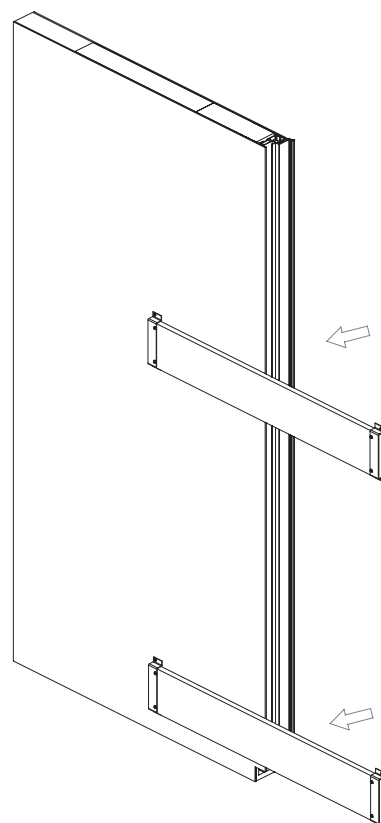
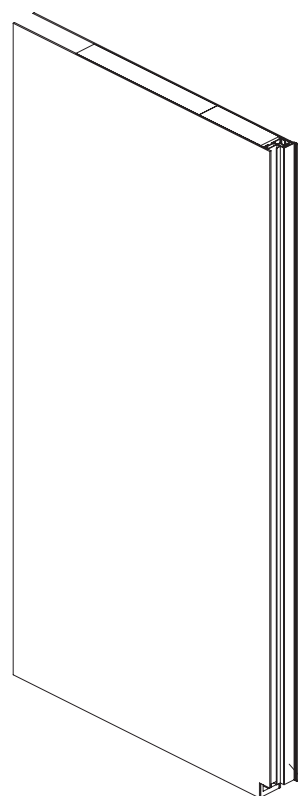

Quitar los separadores
Remove spreaders

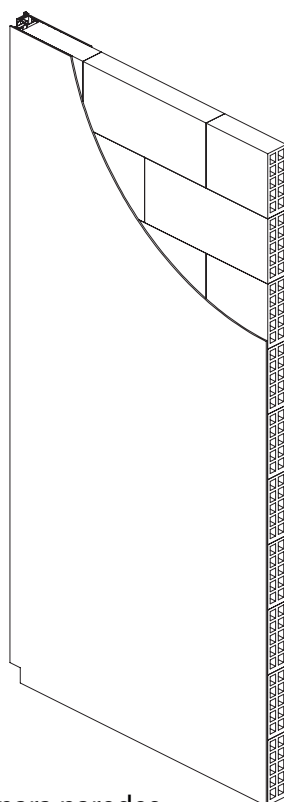

Quitar la lámina protectora de los perfiles.
Los perfiles se pueden pintar con pinturas para paredes.
Remove the protective foil from the profiles.
The profiles can be painted with wall paint.

Se recomienda seguir estas instrucciones utilizando las herramientas adecuadas y de acuerdo con las indicaciones. En el caso de elementos cuya superficie pueda ser afilada, se deben utilizar equipos de protección individual y asegurar el área de trabajo. La empresa se exime de responsabilidad por las acciones resultantes de no seguir estas instrucciones.

It is recommended that you follow these instructions using the appropriate tools as indicated. In the case of elements whose surface can be sharp, use personal protective equipment and work area protection. The company refrains from liability for actions resulting from conduct incompatible with this instruction.